



## Birch Mountain Enterprises Ltd.

Office: 780-824-1128 • Dispatch: 780-881-3351

[www.bmel.ca](http://www.bmel.ca)

## 13' x 8' self contained portable job-site washroom

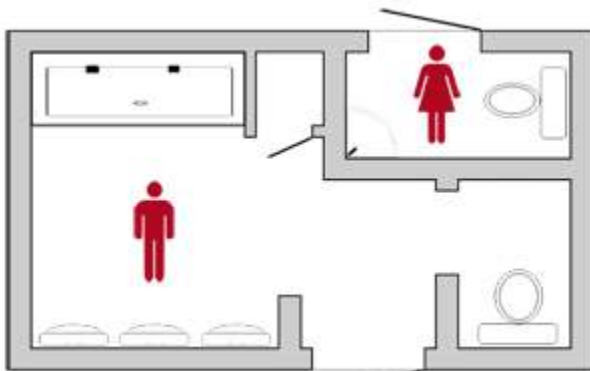

### UNIT SPECIFICATIONS

#### Woman's Side

- 1 toilet
- 1 sink
- 1 mirror
- high output ventilation

#### Men's Side

- 3 waterless urinals
- 1 toilets (separate cubicle)
- 1 large stainless steel wash basin
- 1 mirror
- high output ventilation
- 500 gallon waste holding tank
- 350 gallon fresh water holding tank
- Single phase 240 V – 30 amp power supply
- Durable aluminum floors

Fluid Handling • Waste Handling • Steaming • Hydro Excavating • Bulk Water

BIRCH MOUNTAIN ENTERPRISES GROUP OF COMPANIES



PO Box 5445, Fort McMurray, AB T9H 3G4